



**5/343 Edgecliff Road Woollahra NSW**

4 3 1

Holding fee taken

Spanning across one extensive level, embracing a prized north-easterly aspect, this masterful 1920's apartment exudes quality and a sense of timelessness. Period grandeur and contemporary finesse unite in this elegant rental offering, located in the tightly held 'Castlefield' building of only eight apartments.

Impressive proportions, architectural features and original details

Expansive living areas, soaring ornate ceilings, views to Bellevue Hill

Separate formal dining area, parquetry flooring

Grand master bedroom has views, high ceilings and built-ins

Three additional generous proportioned bedrooms

**View :** <https://www.thepropertylab.com.au/lease/nsw/eastern-suburbs/woollahra/residential/apartment/6198175>



**Gerard Marino**  
**1300 048 125**

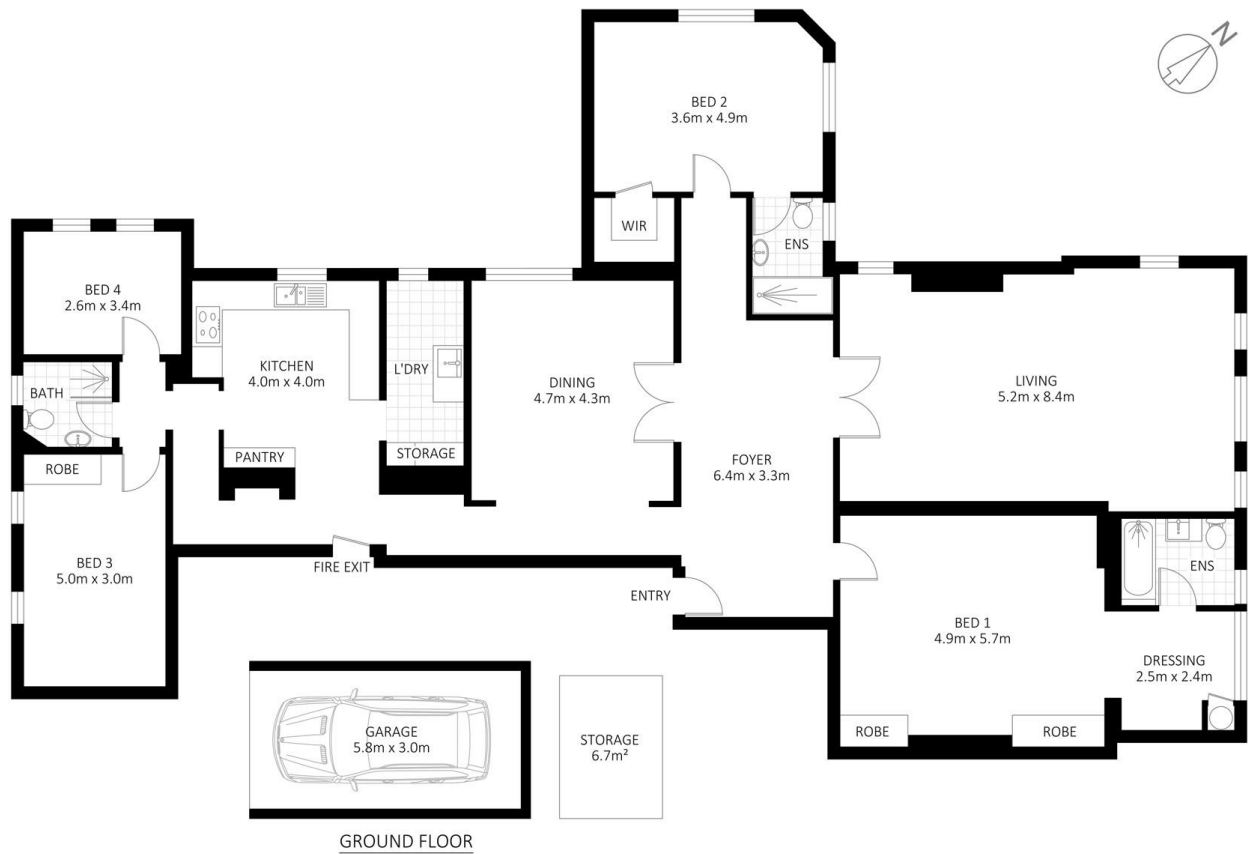

5/343 Edgecliff Road, Woollahra

Disclaimer: Plans shown are for presentation purposes and are not part of any legal document. All measurements and figures are approximate.

THE **Property** LAB