

12/462 Guildford Road Guildford NSW

2  2  1 

Benefiting from a generous floor plan this top floor apartment offers plenty of privacy and convenience.

- Open plan lounge and dining opening to balcony
- Two bedrooms with built-in wardrobes
- Main room with en suite bathroom
- Gas kitchen with ample storage
- Modern bathrooms, internal laundry area
- Lock up garage and second balcony off main bedroom
- Total area 128sqm

Further features include LED downlights, recently installed carpet and repainted in 2018, located within a short drive to local shops, train station and nearby schools.

Available from the 20th of May 2020

View : <https://www.thepropertylab.com.au/lease/nsw/parramatta/guildford/residential/apartment/6198167>



Daniel Beracochea
1300 048 125

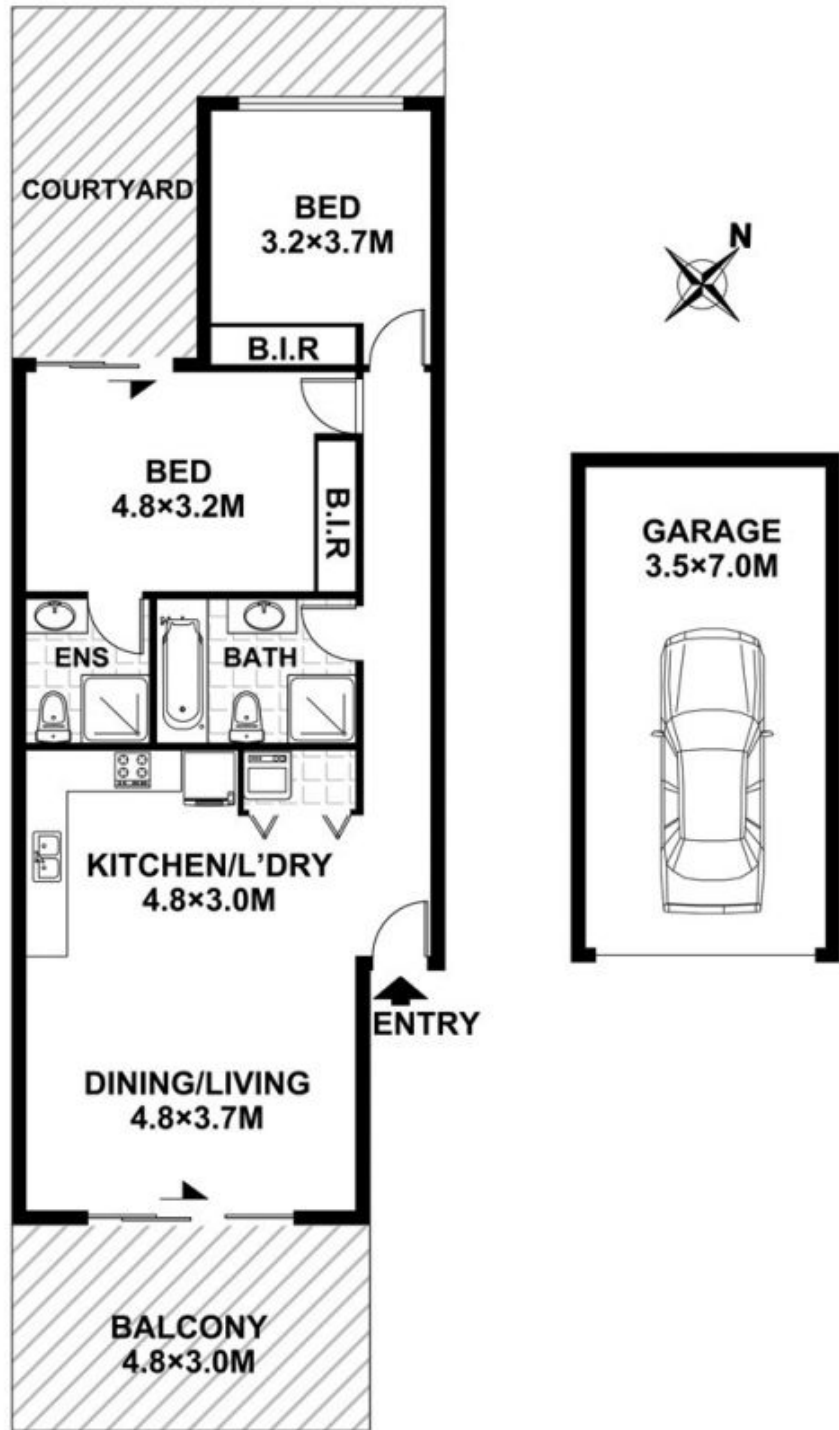

12/462 Guildford Road, Guildford

Disclaimer: Floor plans and site plans are intended as a guide only. They are not part of any legal document or title and are subject to errors, omission, and inaccuracies and should not be used as reference. Sizes and dimensions are approximate only. Interested parties should make their own enquiries.